



INDUSTRIAL TECTONICS INC
 7222 W. Huron River Drive
 Dexter, MI 48130



SINGLE END PLUG GAGE -- NO HANDLE

Please answer all questions completely by filling in the information in the “Answer” column below. Reference: General Drawing 15BSGAG.

<u>QUESTION</u>	<u>ANSWER</u>																				
1. What is drawing dimension “A” the Ball Size?																					
2. Is the Ball a “GO”, “NO GO”, or a “+/-” tolerance?																					
3. What Class – “XX”, “X”, “Y”, or “Z”																					
<u>BALL TOLERANCE FOR SIZE .050" - .750" DIAMETER</u> <table style="width: 100%; border-collapse: collapse;"> <thead> <tr> <th style="width: 15%;"></th> <th style="width: 15%;">Class XX</th> <th style="width: 15%;">Class X</th> <th style="width: 15%;">Class Y</th> <th style="width: 15%;">Class Z</th> </tr> </thead> <tbody> <tr> <td>GO</td> <td>+0.00002</td> <td>+0.00004</td> <td>+0.00007</td> <td>+0.00010</td> </tr> <tr> <td>NO-GO</td> <td>-0.00002</td> <td>-0.00004</td> <td>-0.00007</td> <td>-0.00010</td> </tr> <tr> <td>STD</td> <td>+/-0.00001</td> <td>+/-0.00002</td> <td>+/-0.000035</td> <td>+/-0.00005</td> </tr> </tbody> </table>		Class XX	Class X	Class Y	Class Z	GO	+0.00002	+0.00004	+0.00007	+0.00010	NO-GO	-0.00002	-0.00004	-0.00007	-0.00010	STD	+/-0.00001	+/-0.00002	+/-0.000035	+/-0.00005	
	Class XX	Class X	Class Y	Class Z																	
GO	+0.00002	+0.00004	+0.00007	+0.00010																	
NO-GO	-0.00002	-0.00004	-0.00007	-0.00010																	
STD	+/-0.00001	+/-0.00002	+/-0.000035	+/-0.00005																	
4. What is the “shank length” dimension and tolerance from the bottom of the ball to the end of the stem? If not specified the shank length will be per the standard shank length on the ITI drawing.																					
5. What is the “shank diameter” dimension and tolerance? If not specified the shank diameter will be per the standard shank diameter on the ITI drawing.																					



INDUSTRIAL TECTONICS INC
 7222 W. Huron River Drive
 Dexter, MI 48130



RETENTION OF LEGENDS

"The subject of this document shall not remove or alter any legend and all legends shall be included on any portion or whole reproduction of this document."

CONFIDENTIALITY STATEMENT AND DISCLAIMER

This document contains CONFIDENTIAL and PROPRIETARY design information originated by INDUSTRIAL TECTONICS INC. (hereinafter ITI). All design, manufacturing, reproduction, use and sale rights regarding this document are expressly reserved by ITI. This document is submitted under a confidential relationship for a specific purpose, and the recipient agrees by accepting this document not to supply or disclose any information regarding it to any third party, in whole or in part, or to incorporate in any other project any special features peculiar to the design illustrated in this document without the express written consent of ITI. All patent rights to the design illustrated in this document are expressly reserved by ITI. All copyrights in this document are expressly reserved by ITI. This document is protected under the copyright laws of the United States as an unpublished work. Possession of this document confers no rights to use the information contained therein for manufacturing purposes, and ITI MAKES NO WARRANTY THAT SUCH INFORMATION IS COMPLETE OR THAT ANYTHING PROVIDED IS FIT FOR ANY PARTICULAR PURPOSE.

REVISIONS					
REV.	DESCRIPTION	BY	DATE	CHK'D	DATE
A	REVISED	RWH	9/97	RWH	9/97

CUSTOMER APPROVAL: _____
 SALES ORDER NUMBER: _____
 PART NUMBER: _____
 SALES ORDER DUE DATE: _____
 SALES COORDINATOR: _____ DATE: _____
 QUANTITY NEEDED: _____
 ADDITIONAL INSTRUCTIONS: _____

	DATE	INITIAL
STKROOM ISSUE		
GAGE SIZE *		(A)
MANUFACTURING		
GAGE SIZE *		
QUALITY CONTROL		
VISUAL INSPECTION		
SHIPPING		

* = ATTACH GAGE TAPE TO PRINT

BALL TOLERANCE FOR SIZE .050 - .750 DIAMETER				
	CLASS XX	CLASS X	CLASS Y	CLASS Z
"GO"	+0.0002	+0.0004	+0.0007	+0.0010
"NO-GO"	-0.0002	-0.0004	-0.0007	-0.0010
"STD"	+/-0.0001	+/-0.0002	+/-0.00035	+/-0.0005

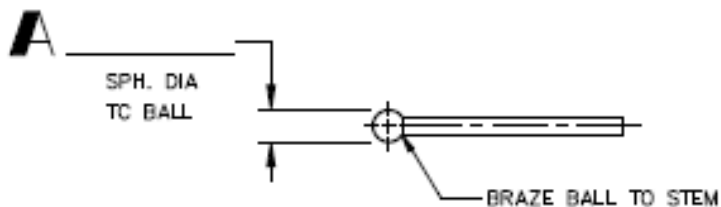

A DIA.	SHANK P/N	SHANK DIA.	SHANK LENGTH
.0500 - .0900	3150014	.045	2.00
.0630 - .1250	3150015	.062	
.0940 - .1920	3150016	.093	
.1570 - .3120	3150017	.156	2.50
.1880 - .3750	3150018	.187	
.2510 - .5000	3150019	.250	
.3760 - .7500	3150020	.375	

UNLESS OTHERWISE SPECIFIED TOLERANCES ARE: FRACTIONS= ± .XX±. 010 ANGLES= ± 1° .XXX±. 005 BREAK ALL SHARP CORNERS: R2 x 45°	DRAWN	CHECKED	INDUSTRIAL TECTONICS INC. A KAYDON COMPANY DEXTER, MICHIGAN	SHEET NUMBER	
	HECKAMAN	JCC		1 OF 1	
	10-13-93	10-13-93		PART NUMBER	REV.
	SCALE NONE	REQ'D.			
	MATERIAL SEE ABOVE	DO NOT SCALE		(15'S) BALL ON STEM PLUG GAGES (TAB.)	